

MATERIAUX: FONTE GRISE

PORTES DE CHEMINÉE

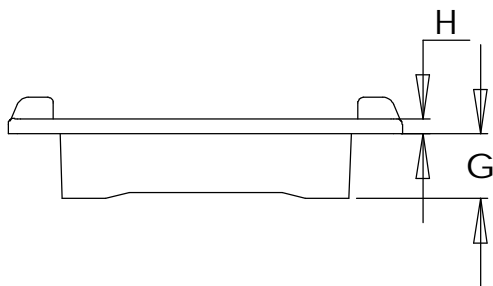

	6X6	7X7	8X8	9X9	10X10	12X12
A	6 1/8" 156 MM	7 1/8" 181 MM	8 1/8" 206 MM	9 1/8" 232 MM	10 1/8" 257 MM	12 3/4" 324 MM
B	6 1/4" 159 MM	7 1/8" 181 MM	8 1/8" 206 MM	9 1/8" 232 MM	10 1/8" 257 MM	12 3/4" 324 MM
C	8 3/8" 213 MM	9 3/8" 238 MM	9 7/8" 251 MM	10 7/8" 276 MM	12 7/8" 327 MM	15 1/2" 394 MM
D	8 3/8" 213 MM	9 3/8" 238 MM	9 7/8" 251 MM	10 7/8" 276 MM	12 7/8" 327 MM	15 1/4" 387 MM
E	5 3/4" 147 MM	6 1/2" 165 MM	7 1/4" 184 MM	8 1/8" 206 MM	9 5/8" 245 MM	12 1/8" 308 MM
F	5 5/8" 144 MM	6 5/8" 168 MM	7 1/4" 184 MM	8 1/8" 206 MM	9 5/8" 245 MM	12 1/8" 308 MM
G	1 3/8" 35 MM	1 3/8" 35 MM	1 1/2" 39 MM	1 1/2" 39 MM	2" 51 MM	2" 51 MM
H	1/4" 6 MM	1/4" 6 MM	1/4" 6 MM	1/4" 6 MM	5/16 8 MM	5/16 8 MM

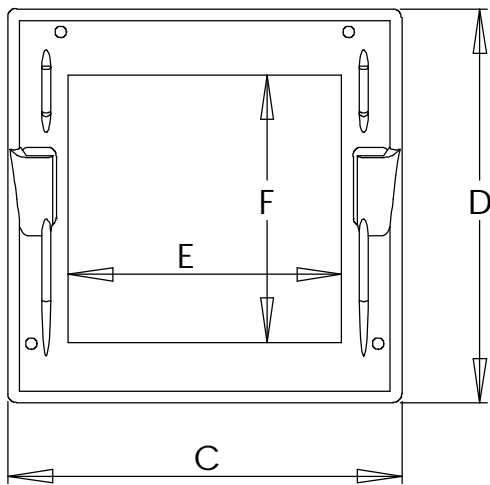
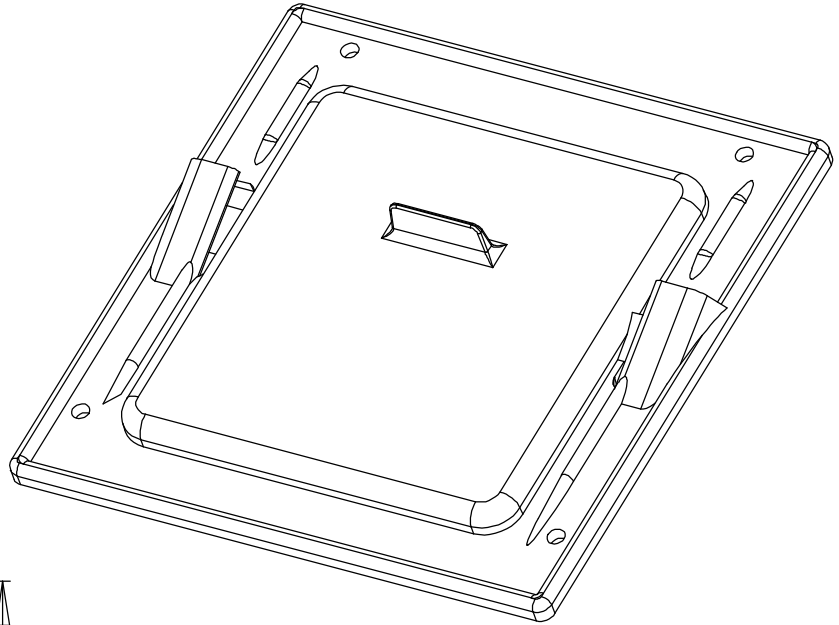
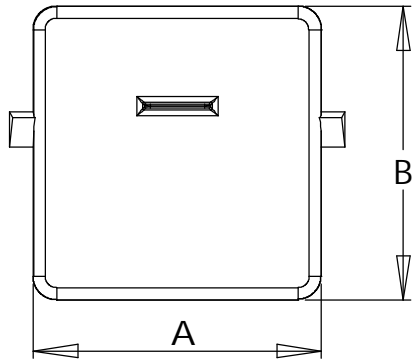

Fonderie Laroche Itée
Pont-Rouge (Québec)
G3H 3M4

Tel.: (418) 873-2516
Fax.: (418) 873-4669

POIDS	LBS	KG
Porte & Cadre 6X6	5	2.3
Porte & Cadre 7X7	6	2.7
Porte & Cadre 8X8	9	4.1
Porte & Cadre 9X9	11	5
Porte & Cadre 10X10	13	5.9
Porte & Cadre 12X12	16	7.3